

Layout Plan
Retaining Wall RW 4
M=1:1000

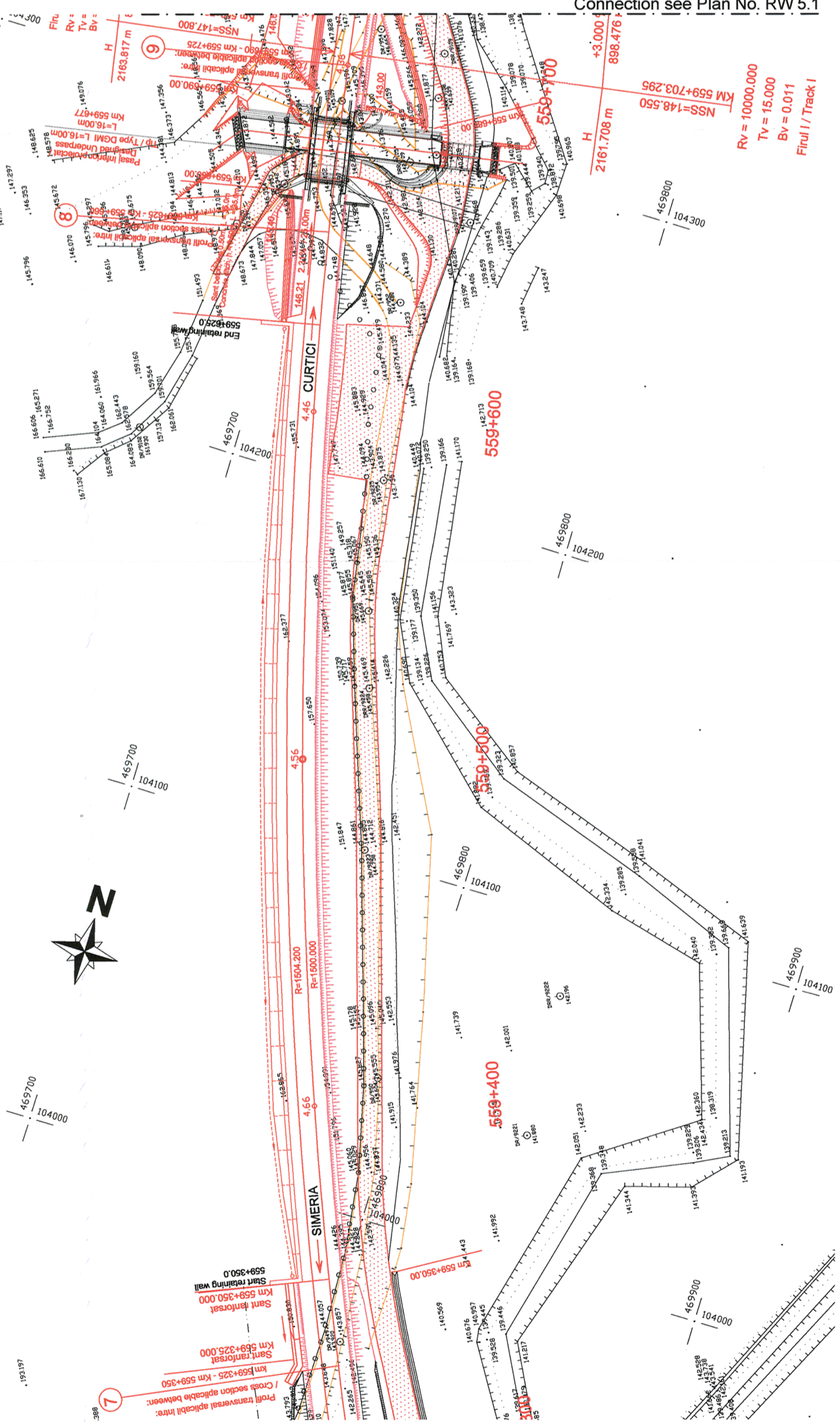

NOTE:

- This plan was prepared based on the following data:
 - topographic survey; geotechnical study; technical expertise; data collected on the site;
- In order to make the retaining walls, the following works will be carried -out:
 - Excavation pit from top to floor and supporting the slopes with shotcrete and micropiles
 - Installation of drainage pipe and drainage matting
 - Construct of the final shell from bottom to top
 - Construction of the drainage ditch at the top
 - Mounting of the handrail
 - Recultivation of the upper slope
- During the execution, the provisions of the following documents will be strictly observed:
 - Practice code for the execution of works made of concrete, reinforced concrete and prestressed concrete, indicative NE 012-2007;
 - Practice code for the execution of the precast elements made of concrete, reinforced concrete and prestressed concrete, indicative NE 013-2002;
 - Normative for quality checking and taking over of afferent construction works, indicative C56-85
 - The Technical Specifications.
- Complying with H.G. 766/1997 this structure belongs to category "B" of importance.
- The project will be verified at A.4, B.2 and D.2 requirements.

OBSERVATE:

- Pe toate suprafețele din beton în contact cu pământul se vor aplica 2 straturi de emulsie din bitum filerizat.
- Protecția betonată a albie se va executa cu rosturi conform C.S.

ATTENTON:

- All concrete surfaces in contact with soil will be coated with 2 bituminous layers.
- The concrete protection of the riverbed will be executed with joints according with technical specifications.

NOTA:

Pentru trasarea lucrărilor se vor folosi ca repere în plan axele liniilor c.f. iar ca repere de nivel cota NSS(Pr.).

NOTA:

For setting out the works, the axes of the railway lines will be utilized as reference marks in plan and the NSS(Dsg.)(top of the rail).

Longitudinal section	M 1:1000	RW 4.2
Regular Cross section, H = 0 to 7 m	M. 1:50	RWC 1
Regular Cross section, H = 7 to 13 m	M. 1:50	RWC 2
Regular Cross section, H = 13 to 15 m	M. 1:50	RWC 3
Regular Cross section, H = 15 to 19 m	M. 1:50	RWC 4
Regular Cross section, H = 19 to 22.5 m	M. 1:50	RWC 5
Details	M. 1:10, 1:25	RWD 1



Verificator / Expert
Checker / Expert

Referat / Expertiza
Report / Expertise

Semnatura
Signature

MINISTERUL
TRANSPORTURILOR

BENEFICIAR / BENEFICIARY :



COMPANIA NAȚIONALĂ DE CĂI FERATE "CFR" SA

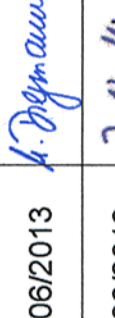
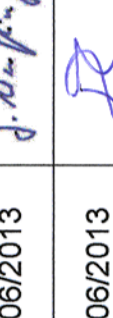
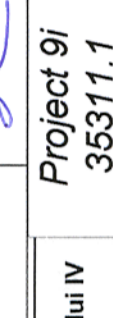

PROIECTANT / DESIGNER:

Approbat Approved	Sef de echipa Team leader	C. Teodorescu	Data Date	06/2013	Semnatura Signature	
Verificat Checked	Expert Cheie Key Expert	M. Diegmann		06/2013		
Approbat Approved	Adjunct Sef de echipa Deputy Team leader	J. Werfling		06/2013		
Proiectat Designed	Inginer Engineer	D. Ciotarnel		06/2013		

"Reabilitarea liniei c.f. Frontieră - Curtici - Simeria, parte componentă a coridorului IV Pan - European pentru circulația trenurilor cu viteză maximă de 160 km/h"

Tronsonul 2: km 614-Gurasada

"Rehabilitation of the Railway Line Border - Curtici - Simeria, component Part of the IV Pan - European Corridor for the Trains Circulation with maximum speed of 160 km/h"

Section 2 :km 614-Gurasada

Denumire desen / Drawing name:
PLAN DE SITUATIE
LAYOUT PLAN - RETAINING WALL RW 4
km 559+350 - km 559+625

Scara / Scale
1:1000

Cod desen / Drawing Code
RW 4.1

Nr / No
RW 4